

Wireless Self-Powered Dimming Kinetic Wall Controller

Overview

- Compatible with TruBlu™ Mesh
- Self-Powered (Battery Less)
- Manual On/Off (Wireless Switching)
- Wireless Dimming
- Tunable White Capability
- Surface or Recessed Mounting (Standard Wall Box)



PSC-MO-WS-100-BLE-SR PSC-MO-WS-400-BLE-SR



Applications

mwConnect's Wireless Self-powered wall switches (PSC-MO-WS Series) provide automatic lighting control for a variety of indoor applications.

These devices do not require wires or batteries; they utilize an integrated micro-generator powered Bluetooth BLE transmitter to send a wireless signal.

Typical applications include private offices, open offices, classrooms, conference rooms and any application where running power or control wiring is impossible or undesirable. A standard decorator style opening allows for easy multigang installations.

Operation

PSC-MO-WS Series Bluetooth Switches offer a familiar and convenient interface for communicating with compatible controllers. Each switch must be paired with at least one device or node to operate in a wireless mesh lighting control network.

The single-button unit provides ON/Raise and OFF/Lower for one zone of lighting.

The four-button unit provides ON/Raise and OFF/Lower for one zone of lighting with Scene control or control of dual-channel zones tunable warm/cool lighting systems. The device can also be programmed for override control.

See Commissioning User Manual for more information.

Summary

Product Type:
Wall Switch/Controller

Input Voltage | Power Consumption:
Self-powered

Mounting:
Surface or Flush Mount

Max Bluetooth Range:
30ft (9.14m)

Operating Temperature:
-4°F to 131°F (-20°C to 55°C)

Storage Temperature:
-4°F to 131°F (-20°C to 55°C)

Relative Humidity:
90-95% non-condensing at 30°C

Color: White

Warranty: 5 years

Project

Location/Type

Physical Dimensions

PSC-MO-WS-100-BLE-SR

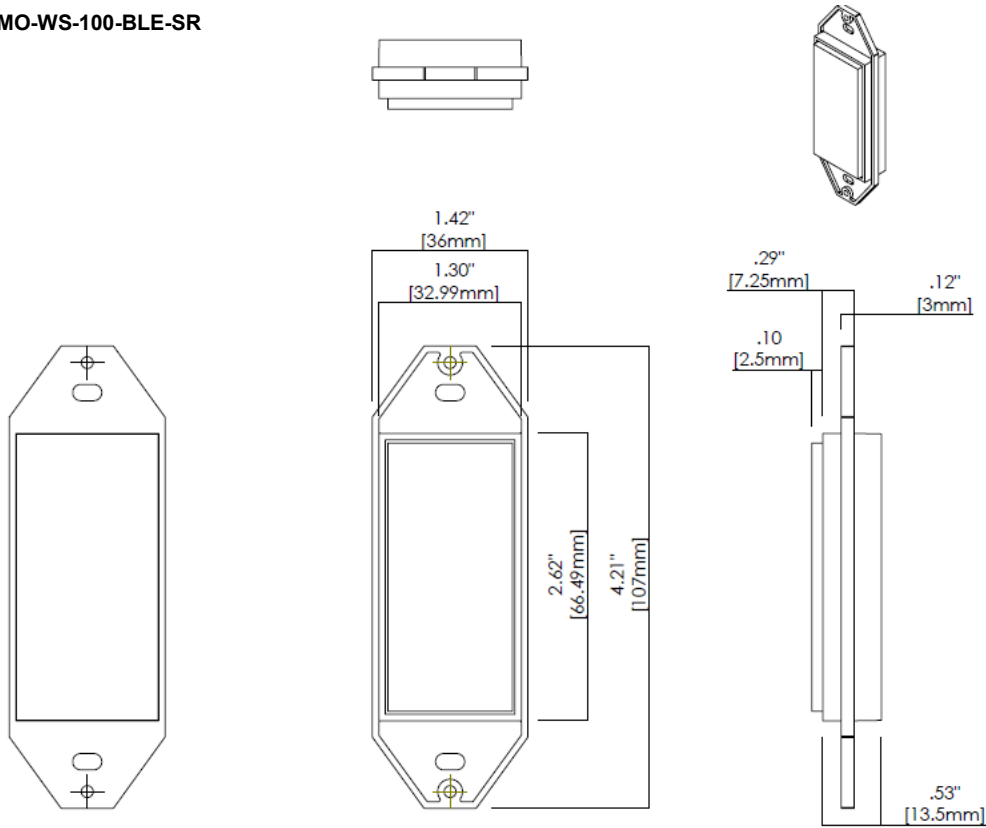

PSC-MO-WS-400-BLE-SR

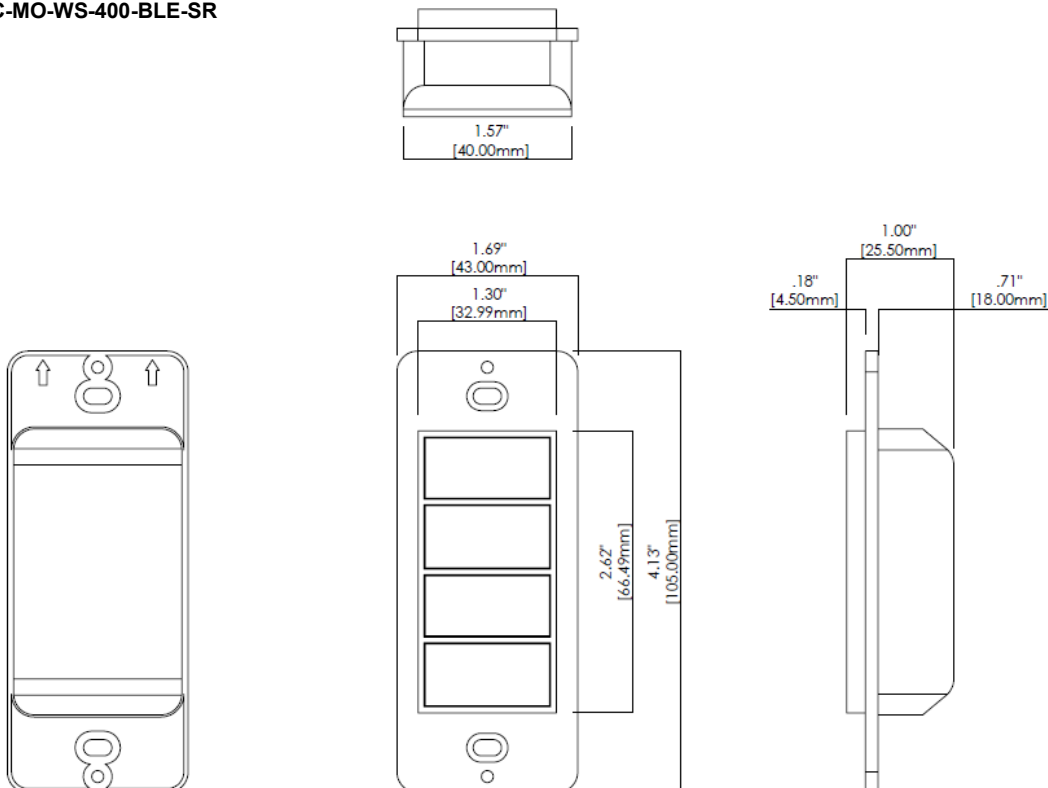

Drawings are not to scale

Wireless Manual Control

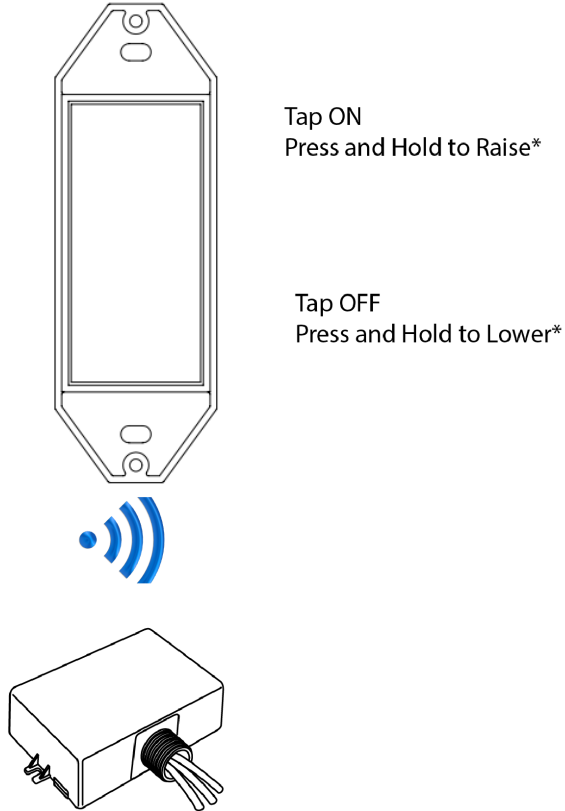

*Requires single-channel controller



*Requires dual-channel controller

How to Order

Model No.	Description
PSC-MO-WS-100-BLE-SR	Wireless single rocker, Self-Powered Dimming Kinetic Wall Controller, compatible with TruBlu™ Mesh
PSC-MO-WS-400-BLE-SR	Wireless four-button, Self-Powered Dimming Kinetic Wall Controller, Scene Control, compatible with TruBlu™ Mesh

Design and specifications are subject to change without notice.