

PSC-JBV-I-11N-BLE-SR | Wireless PIR Motion Sensor – with Audio Jack

Overview

- Bluetooth® NLC Certified
- 1-Channel 0-10VDC Dimming
- PIR Sensor Mounting Height Up To 15ft (4.6m)
- Daylight Harvesting, High-End Trim, Zoning, Continuous Dimming, ON/OFF control
- Indoor rated
- 3.5mm Audio Jack



Applications

The PSC-JBV-I-11N products are a series of 1-Channel Wireless Fixture Controllers and use PIR motion detection architecture and passive infrared (PIR) technology for improved detection coverage.

The controllers are suitable for a variety of indoor applications in temperatures ranging from -20° to 70°C. The models also have an integral photosensor.

These devices are Bluetooth® NLC certified and controlled wirelessly via Bluetooth Mesh technology allowing for wireless dimming of luminaires. The compact size allows for seamless integration to the fixture.

Operation

TruBlu™ Mesh Controls: The PSC-JBV-I-11N sensor-controller is a Bluetooth NLC certified device by the Bluetooth SIG and offers true multi-vendor interoperability. Configuration of the device and mesh network is accomplished via the TruBlu web portal or iOS mobile app. The app is used for initial setup and subsequent parameter adjustment.

Advanced functionality such as energy monitoring, and demand response is available with the TruBlu Gateway (ordered separately). See TruBlu™ Commissioning User Manual for more information.

1-Channel: Outputs 0-10 dimming channel for driver control.

Photosensor: An integral photosensor provides ambient light level sensing for automatic control of daytime or nighttime designated scenarios.

Audio Jack: The controller mounts to a Audio Jack.

Summary

Product Type:
1-Channel PIR Sensor and Controller

Input Voltage | Current Consumption:
12 VDC | 30 mA

Mounting:
Fixture Mount/Audio Jack

Mounting Height:
Fixture mount at 15ft (4.6m)

Max Range¹:
6ft (1.8m) radius

Max Bluetooth Range²:
100ft (30.4m)

Operating Temperature:
-20° C to 40° C

Storage Temperature:
-20° C to 50° C

Relative Humidity:
90-95% non-condensing

Color: White

Warranty: 5 years

Note:

1. Bluetooth Range is highly dependent on the integration of fixtures, surrounding environment and conditions. It is recommended to conduct testing for range accuracy.

Project

Location/Type

Physical Dimensions

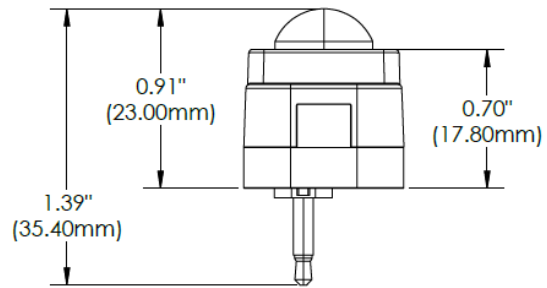
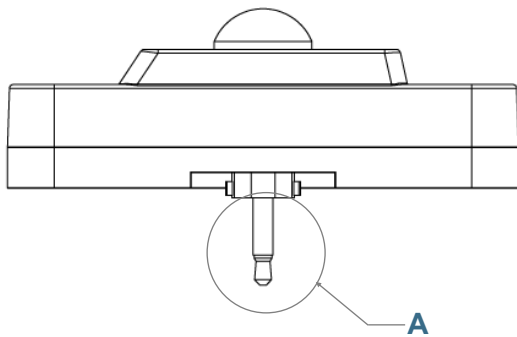
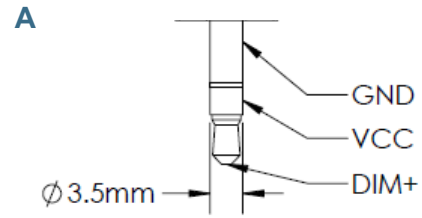
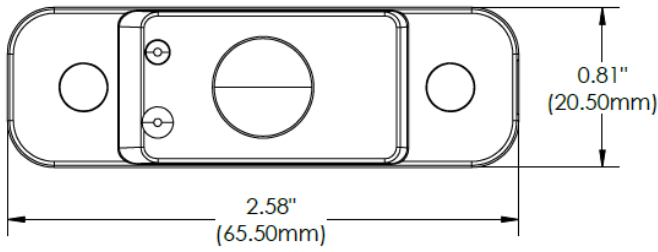

Drawings are Not to Scale

Sensor Patterns

Floor Coverage at 15 ft (4.5m)

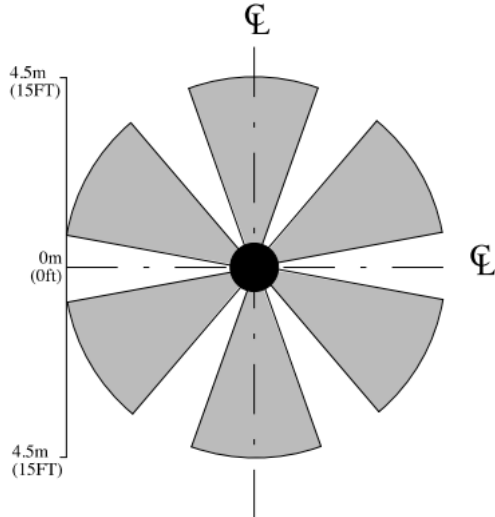

Side View

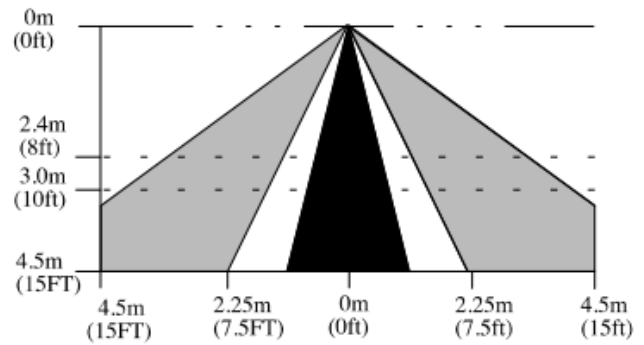

How To Order

Model No.	Description	Input Voltage	Output
PSC-JBV-I-11N-BLE-SR	PIR Sensor-Audio Jack w/ 0-10V Dimming, Daylight Harvesting, Bluetooth Mesh in TruBlu™	12VDC	0-10V Dimming

Design and specifications are subject to change without notice.